

# Prepare



P R O S O C O  
**R-GUARD®**

*Reinforce and bridge  
rough opening preparation  
Joint Fabric and EZCorners*

[www.prosoco.com](http://www.prosoco.com)

**PROSOCO**  
SINCE 1939

**Step A**

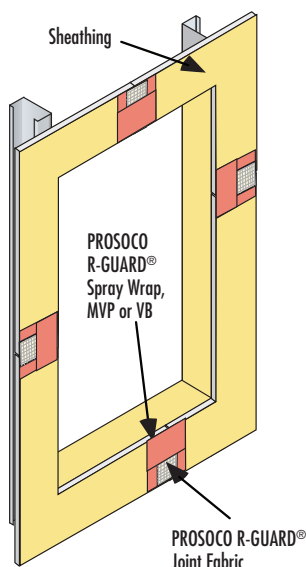

**Step B**

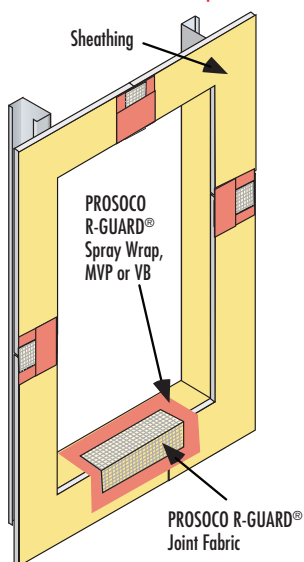

**Step C**

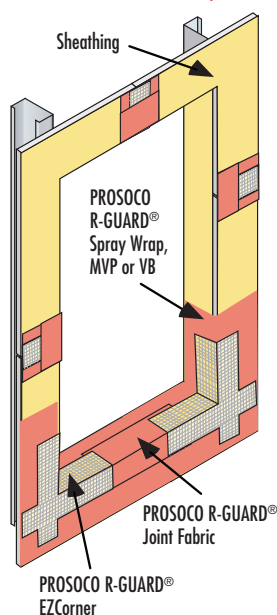

**Step D**

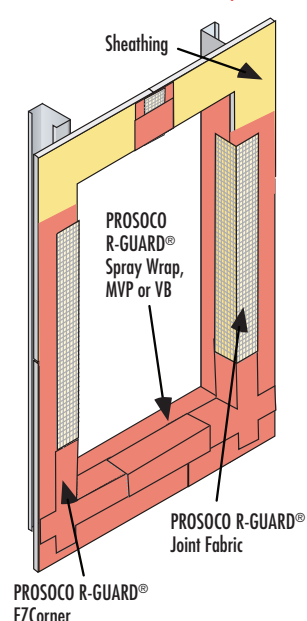

**Step E**

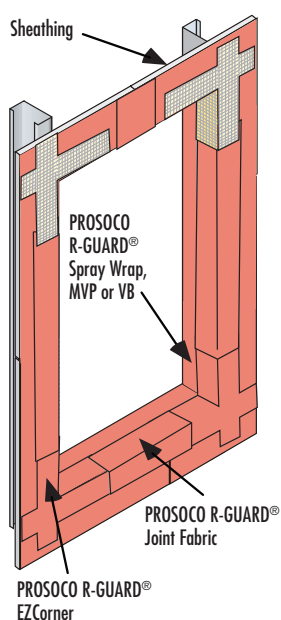

**Step F**

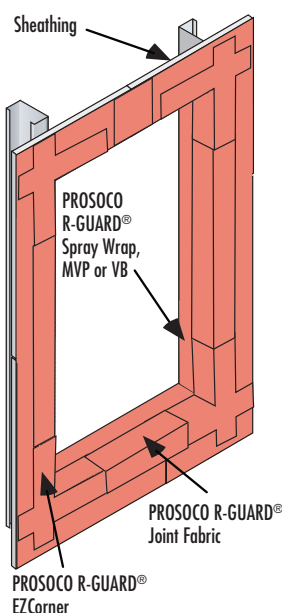

**Step G**

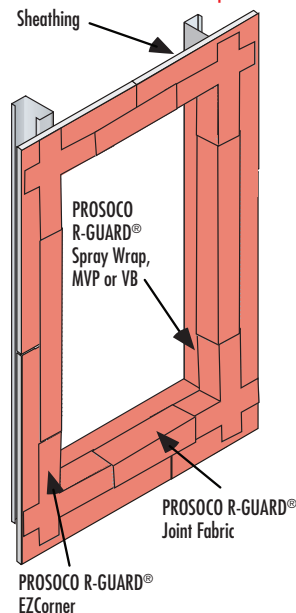

R-GUARD Joint Fabric is  
applied in a shingle fashion  
with at least a 2" overlap